

THIS MAP IS NOT A CERTIFIED SURVEY AND HAS NOT BEEN REVIEWED BY A LOCAL GOVERNMENT AGENCY FOR COMPLIANCE WITH ANY APPLICABLE LAND DEVELOPMENT REGULATIONS.

McGILVARY STREET

|                                                                                                                                              |            |                                                             |
|----------------------------------------------------------------------------------------------------------------------------------------------|------------|-------------------------------------------------------------|
|  <b>FAYETTEVILLE</b>                                     |            | ENGINEERING DIVISION<br>433 HAY ST. 28301<br>(910) 433-1856 |
| <b>PAVEMENT PRESERVATION PROGRAM<br/>         FY24 (GO BOND) PHASE 2<br/>         MILLING &amp; RESURFACING<br/>         VARIOUS STREETS</b> |            |                                                             |
| DATE                                                                                                                                         | 12/11/2023 | DRAWN BY RSH                                                |
| SCALE                                                                                                                                        | 1"=500'    | CK'D BY RSH                                                 |

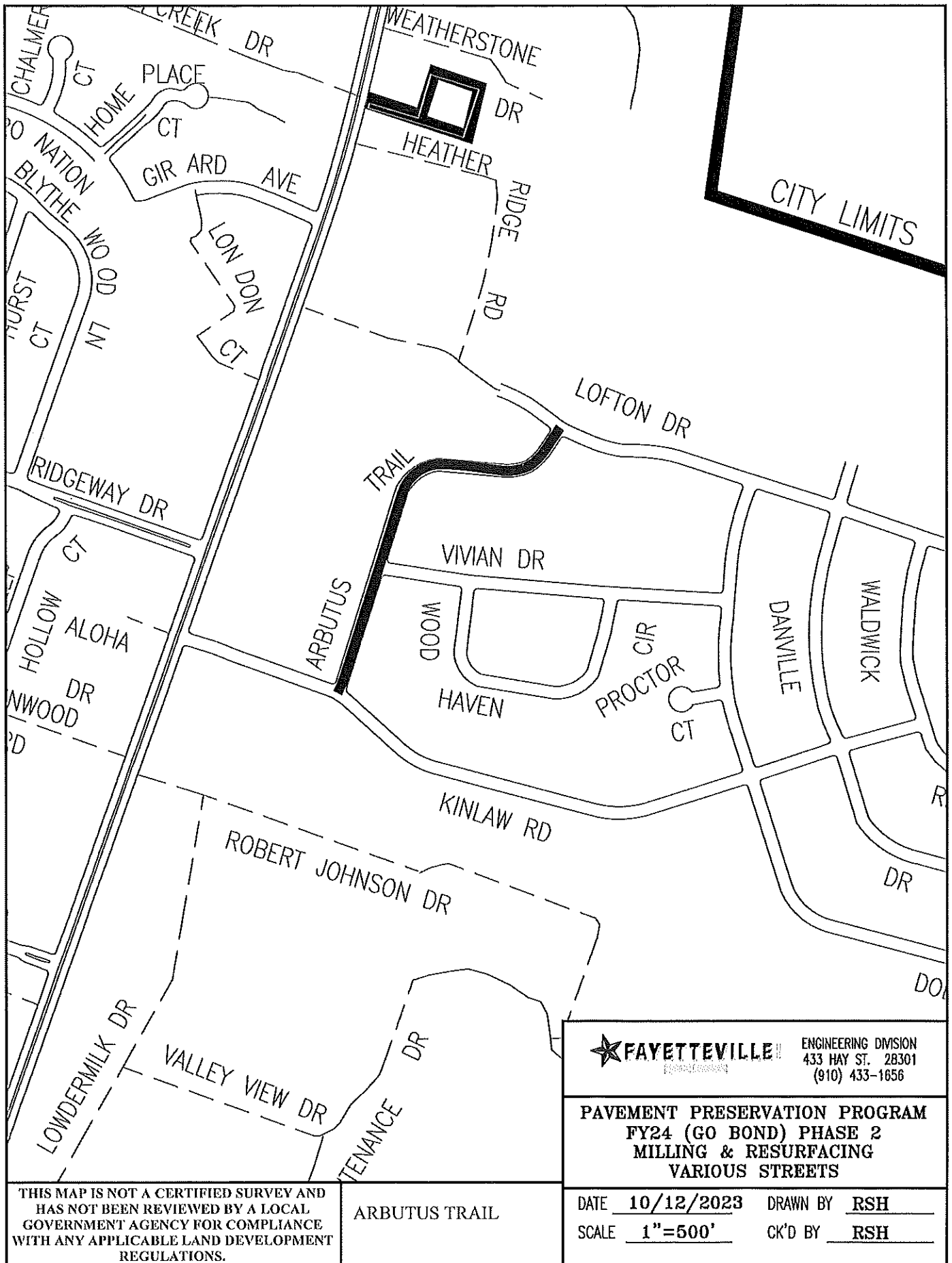

THIS MAP IS NOT A CERTIFIED SURVEY AND HAS NOT BEEN REVIEWED BY A LOCAL GOVERNMENT AGENCY FOR COMPLIANCE WITH ANY APPLICABLE LAND DEVELOPMENT REGULATIONS.

ARBUTUS TRAIL

|                                                                                                                   |                   |                                                             |
|-------------------------------------------------------------------------------------------------------------------|-------------------|-------------------------------------------------------------|
|  <b>FAYETTEVILLE</b>          |                   | ENGINEERING DIVISION<br>433 HAY ST. 28301<br>(910) 433-1656 |
| <b>PAVEMENT PRESERVATION PROGRAM<br/>FY24 (GO BOND) PHASE 2<br/>MILLING &amp; RESURFACING<br/>VARIOUS STREETS</b> |                   |                                                             |
| DATE                                                                                                              | <u>10/12/2023</u> | DRAWN BY <u>RSH</u>                                         |
| SCALE                                                                                                             | <u>1"=500'</u>    | CK'D BY <u>RSH</u>                                          |

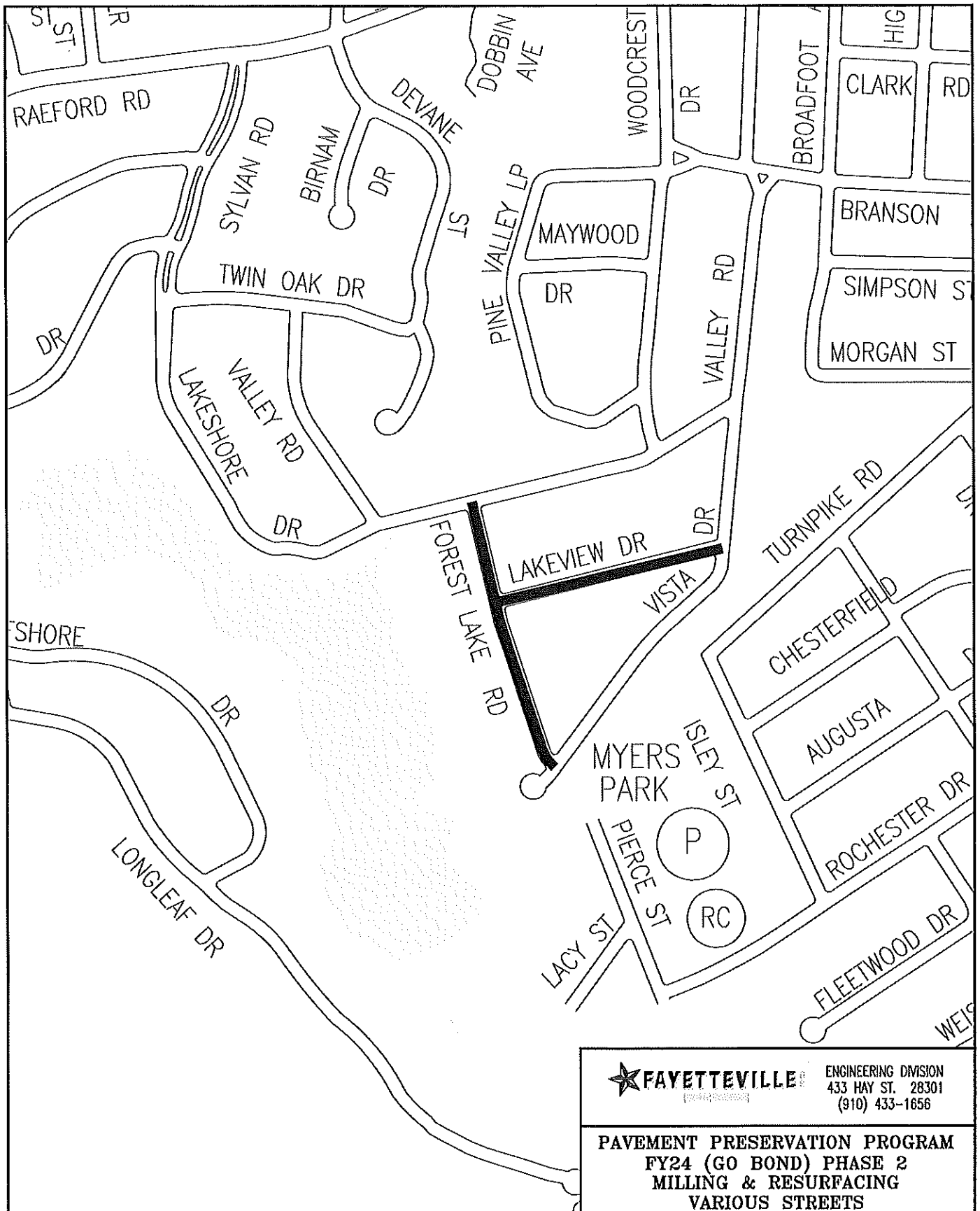

ENGINEERING DIVISION  
433 HAY ST. 28301  
(910) 433-1656

**PAVEMENT PRESERVATION PROGRAM  
FY24 (GO BOND) PHASE 2  
MILLING & RESURFACING  
VARIOUS STREETS**

THIS MAP IS NOT A CERTIFIED SURVEY AND  
HAS NOT BEEN REVIEWED BY A LOCAL  
GOVERNMENT AGENCY FOR COMPLIANCE  
WITH ANY APPLICABLE LAND DEVELOPMENT  
REGULATIONS.

LAKEVIEW DRIVE  
FOREST LAKE ROAD

DATE 10/12/2023

DRAWN BY RSH

SCALE 1"=500'

CK'D BY RSH

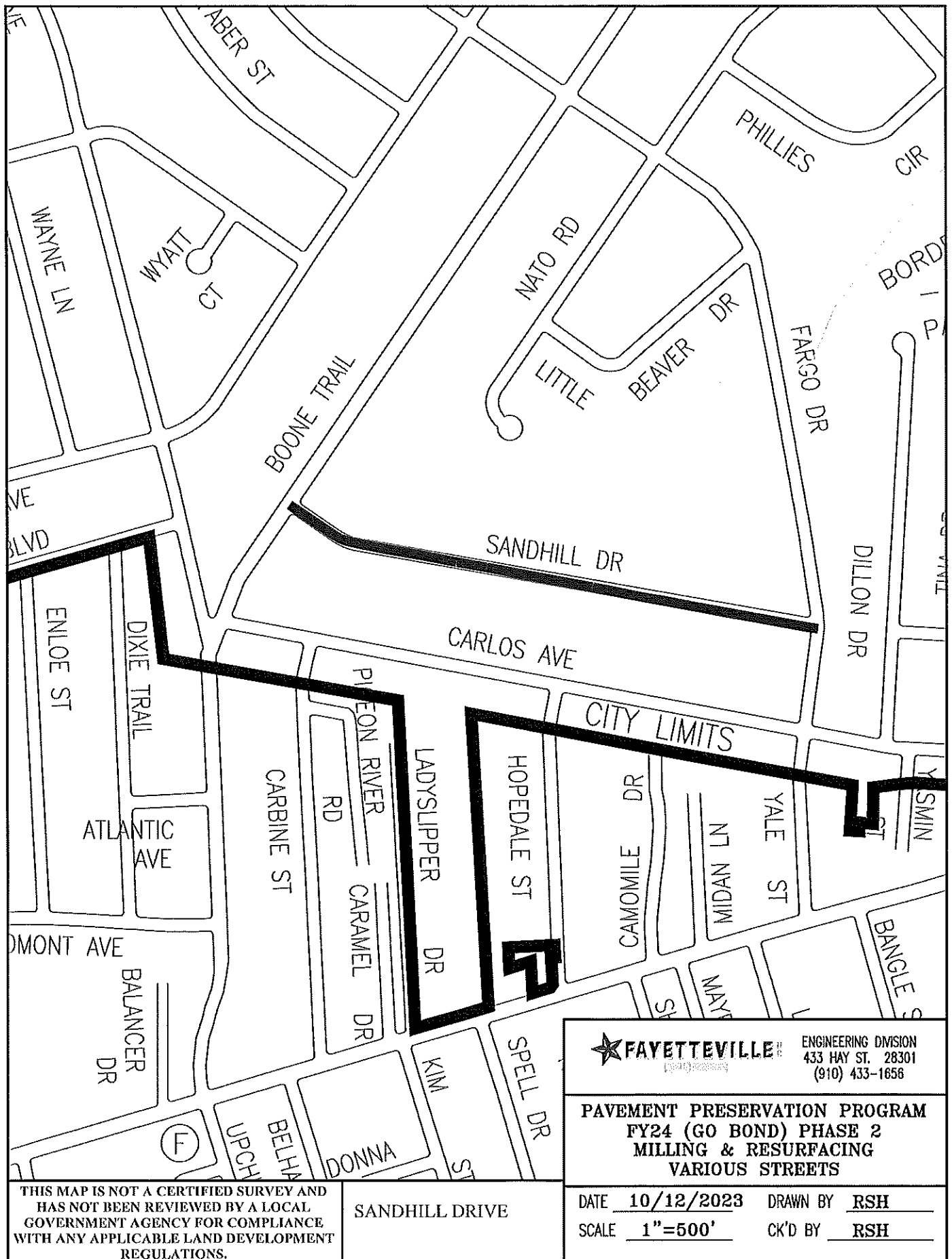

THIS MAP IS NOT A CERTIFIED SURVEY AND  
HAS NOT BEEN REVIEWED BY A LOCAL  
GOVERNMENT AGENCY FOR COMPLIANCE  
WITH ANY APPLICABLE LAND DEVELOPMENT  
REGULATIONS.

SANDHILL DRIVE



**FAYETTEVILLE**

ENGINEERING DMSION  
433 HAY ST. 28301  
(910) 433-1656

**PAVEMENT PRESERVATION PROGRAM  
FY24 (GO BOND) PHASE 2  
MILLING & RESURFACING  
VARIOUS STREETS**

DATE 10/12/2023

DRAWN BY RSH

SCALE 1"=500'

CK'D BY RSH

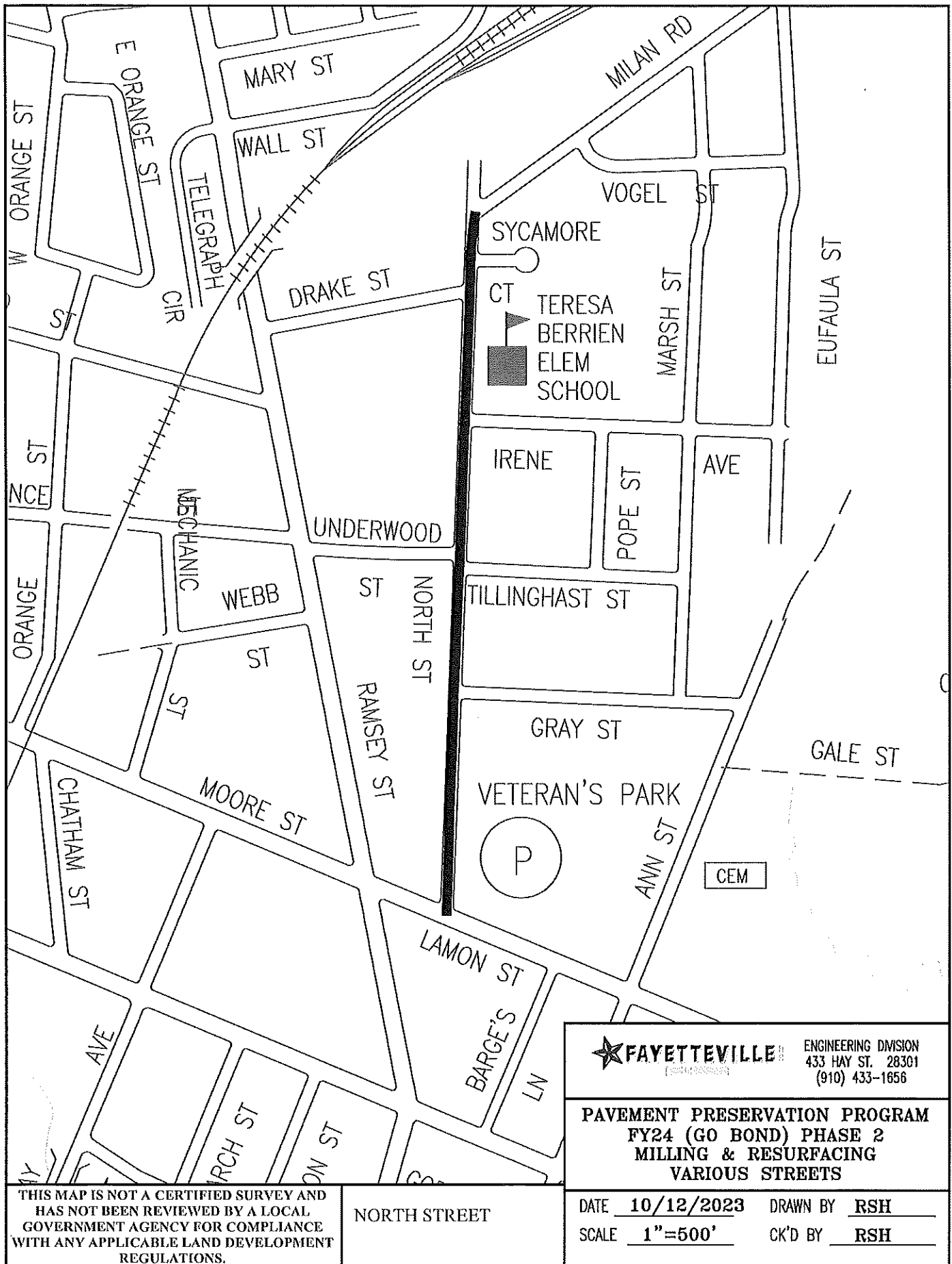

THIS MAP IS NOT A CERTIFIED SURVEY AND HAS NOT BEEN REVIEWED BY A LOCAL GOVERNMENT AGENCY FOR COMPLIANCE WITH ANY APPLICABLE LAND DEVELOPMENT REGULATIONS.

NORTH STREET



ENGINEERING DIVISION  
433 HAY ST. 28301  
(910) 433-1656

PAVEMENT PRESERVATION PROGRAM  
FY24 (GO BOND) PHASE 2  
MILLING & RESURFACING  
VARIOUS STREETS

DATE 10/12/2023

DRAWN BY RSH

SCALE 1"=500'

CK'D BY RSH

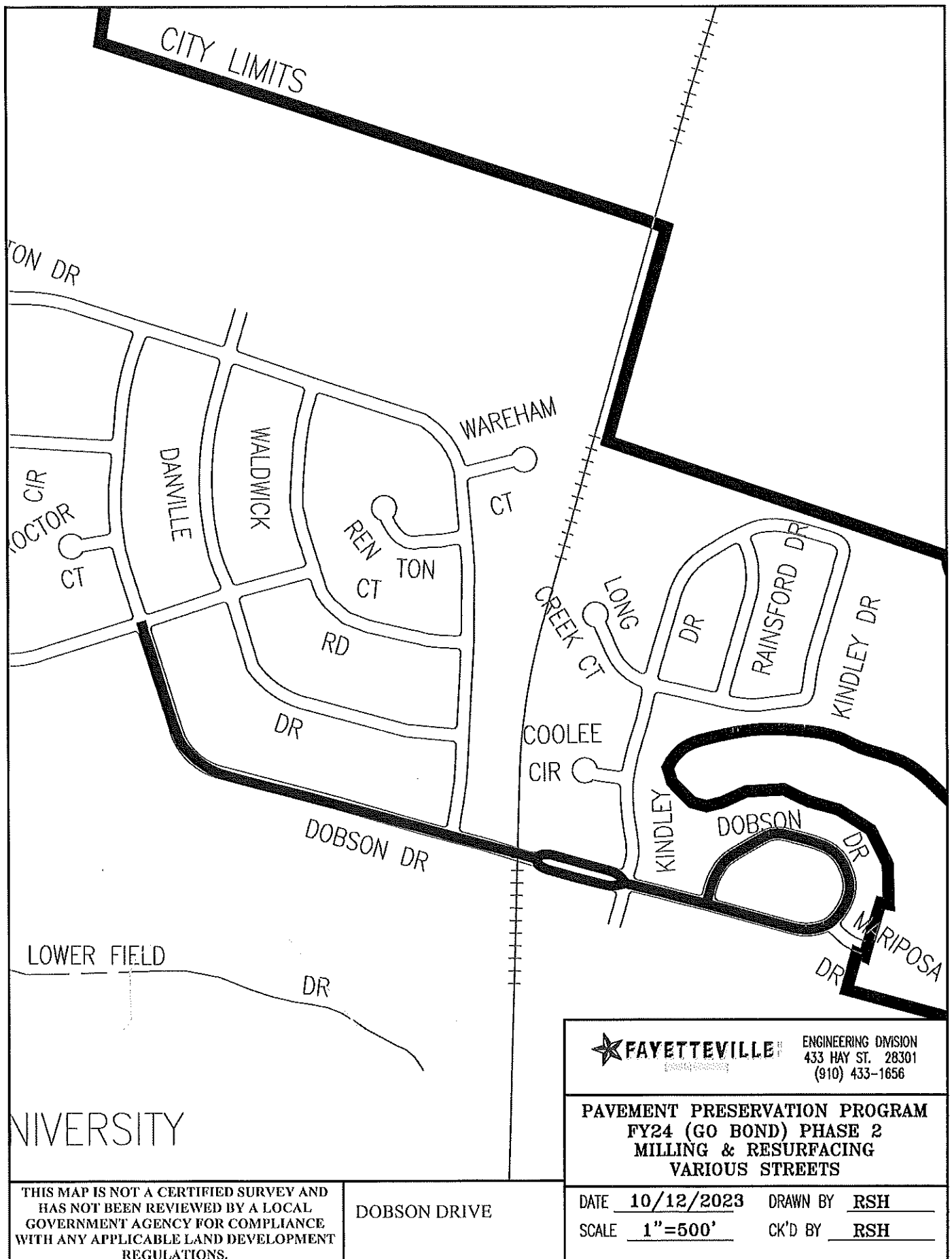

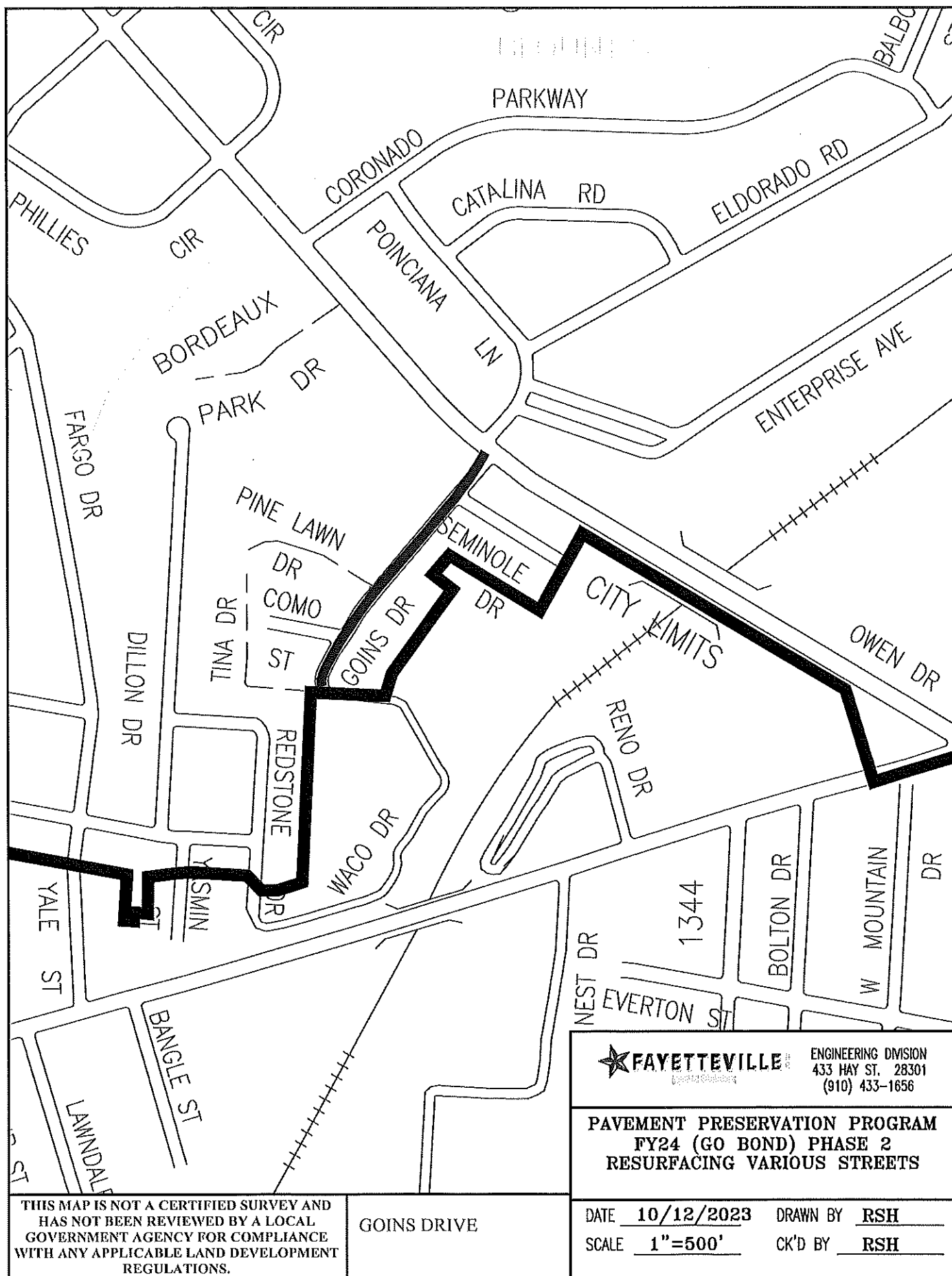

THIS MAP IS NOT A CERTIFIED SURVEY AND HAS NOT BEEN REVIEWED BY A LOCAL GOVERNMENT AGENCY FOR COMPLIANCE WITH ANY APPLICABLE LAND DEVELOPMENT REGULATIONS.

GOINS DRIVE



ENGINEERING DIVISION  
433 HAY ST. 28301  
(910) 433-1656

PAVEMENT PRESERVATION PROGRAM  
FY24 (GO BOND) PHASE 2  
RESURFACING VARIOUS STREETS

DATE 10/12/2023

DRAWN BY RSH

SCALE 1"=500'

CK'D BY RSH

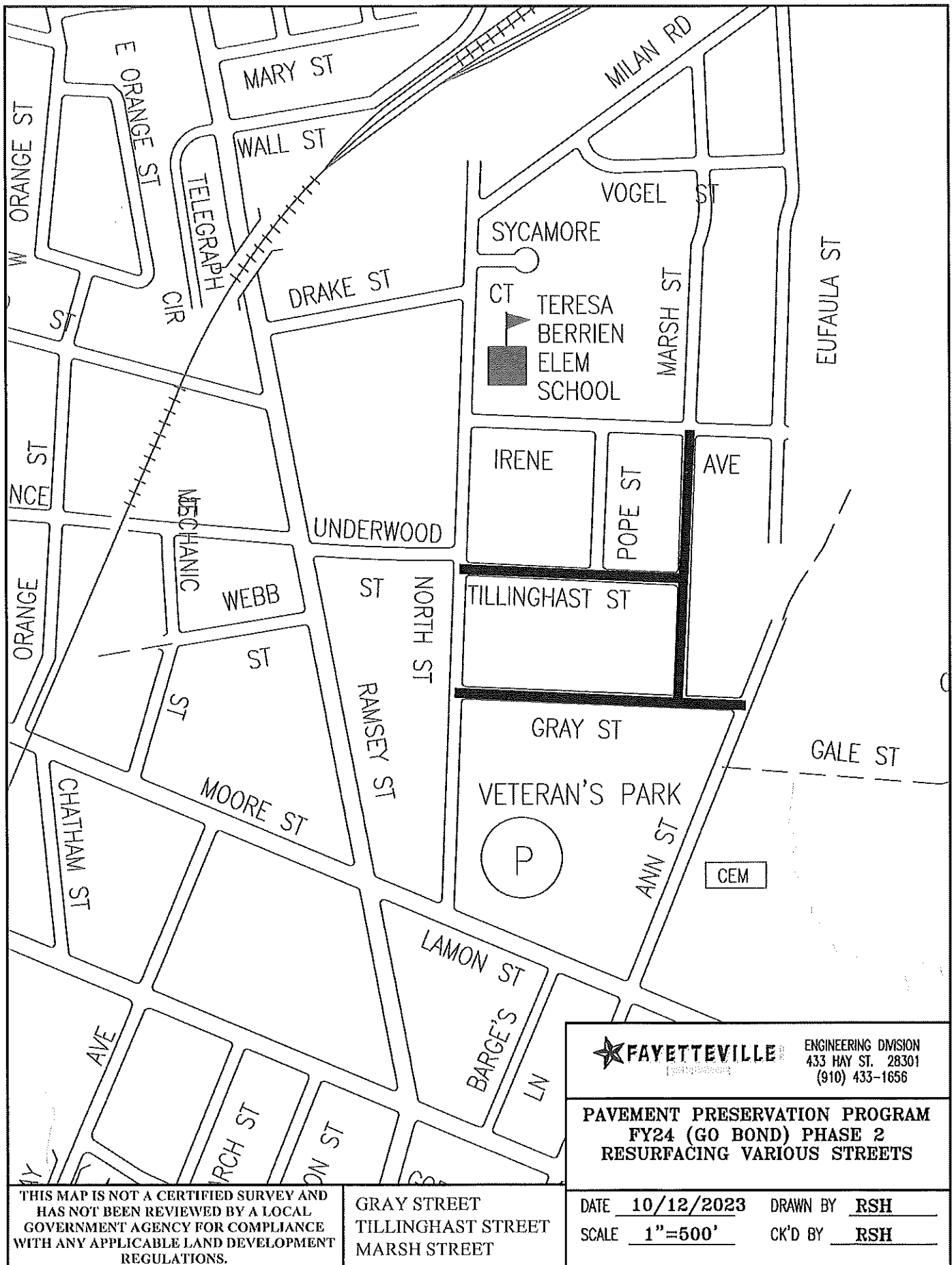

THIS MAP IS NOT A CERTIFIED SURVEY AND HAS NOT BEEN REVIEWED BY A LOCAL GOVERNMENT AGENCY FOR COMPLIANCE WITH ANY APPLICABLE LAND DEVELOPMENT REGULATIONS.

GRAY STREET  
TILLINGHAST STREET  
MARSH STREET



ENGINEERING DIVISION  
433 HAY ST. 28301  
(910) 433-1656

**PAVEMENT PRESERVATION PROGRAM  
FY24 (GO BOND) PHASE 2  
RESURFACING VARIOUS STREETS**

DATE 10/12/2023 DRAWN BY RSH  
SCALE 1"=500' CK'D BY RSH



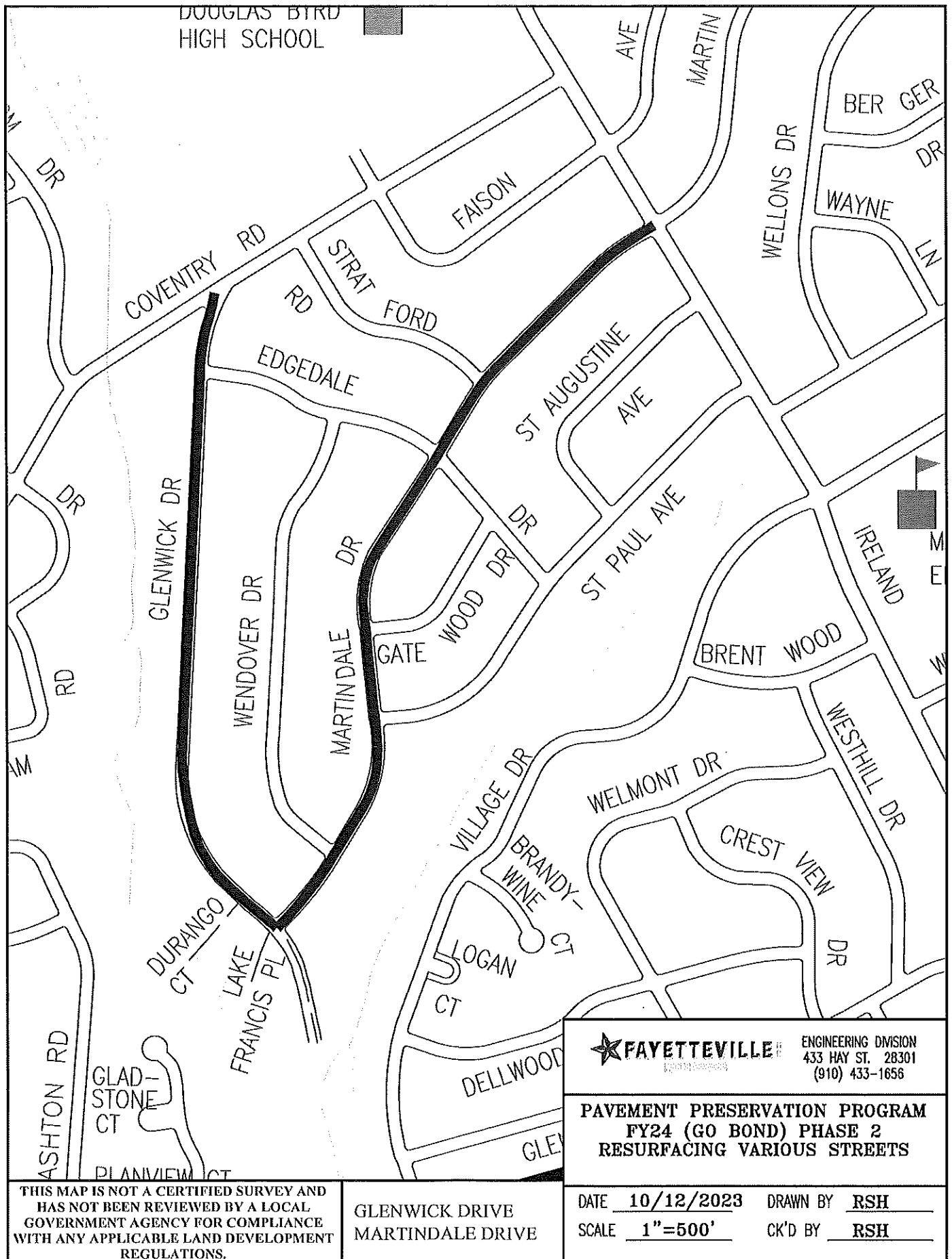

THIS MAP IS NOT A CERTIFIED SURVEY AND  
HAS NOT BEEN REVIEWED BY A LOCAL  
GOVERNMENT AGENCY FOR COMPLIANCE  
WITH ANY APPLICABLE LAND DEVELOPMENT  
REGULATIONS.

GLENWICK DRIVE  
MARTINDALE DRIVE



ENGINEERING DIVISION  
433 HAY ST. 28301  
(910) 433-1656

**PAVEMENT PRESERVATION PROGRAM  
FY24 (GO BOND) PHASE 2  
RESURFACING VARIOUS STREETS**

DATE 10/12/2023

DRAWN BY RSH

SCALE 1"=500'

CK'D BY RSH

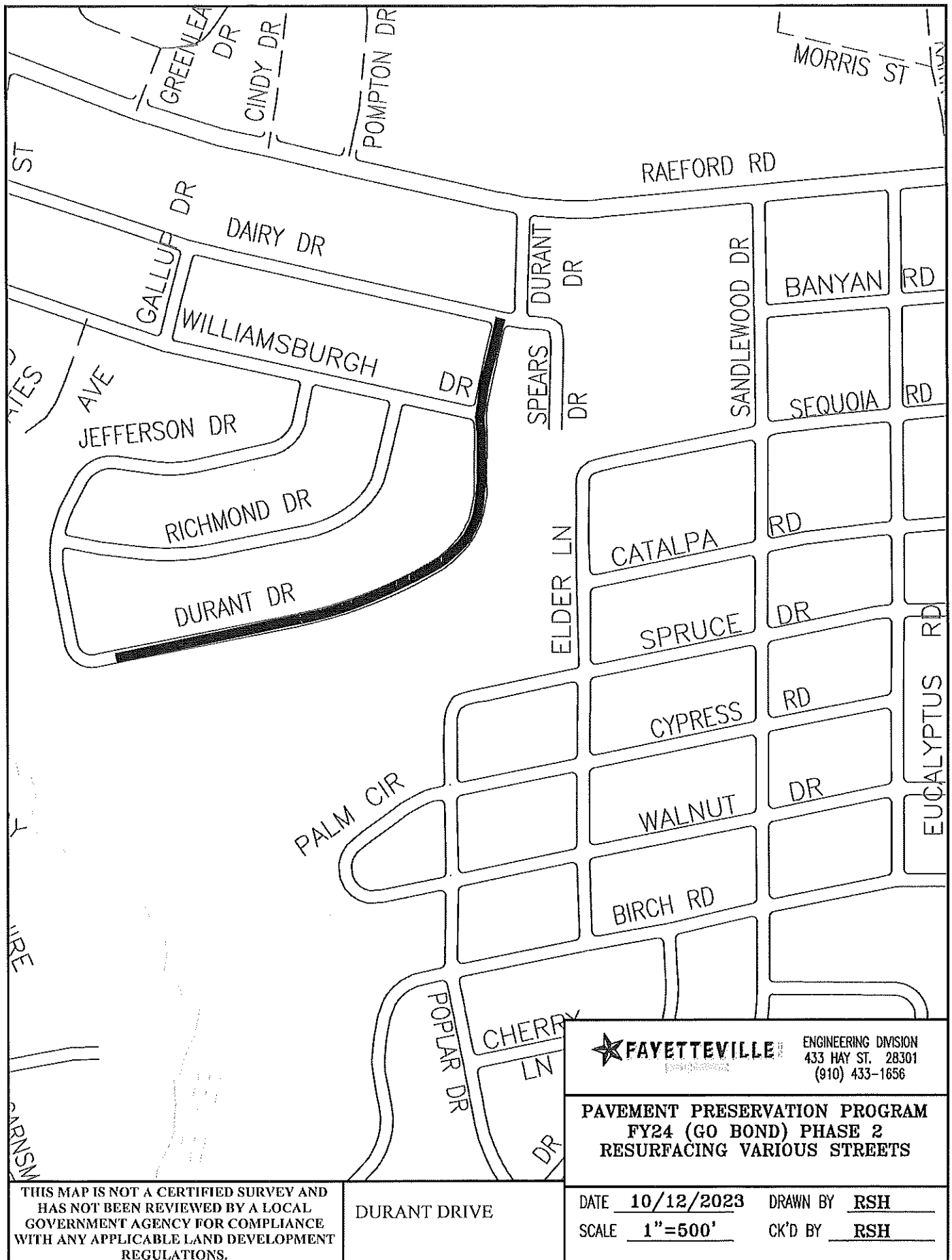

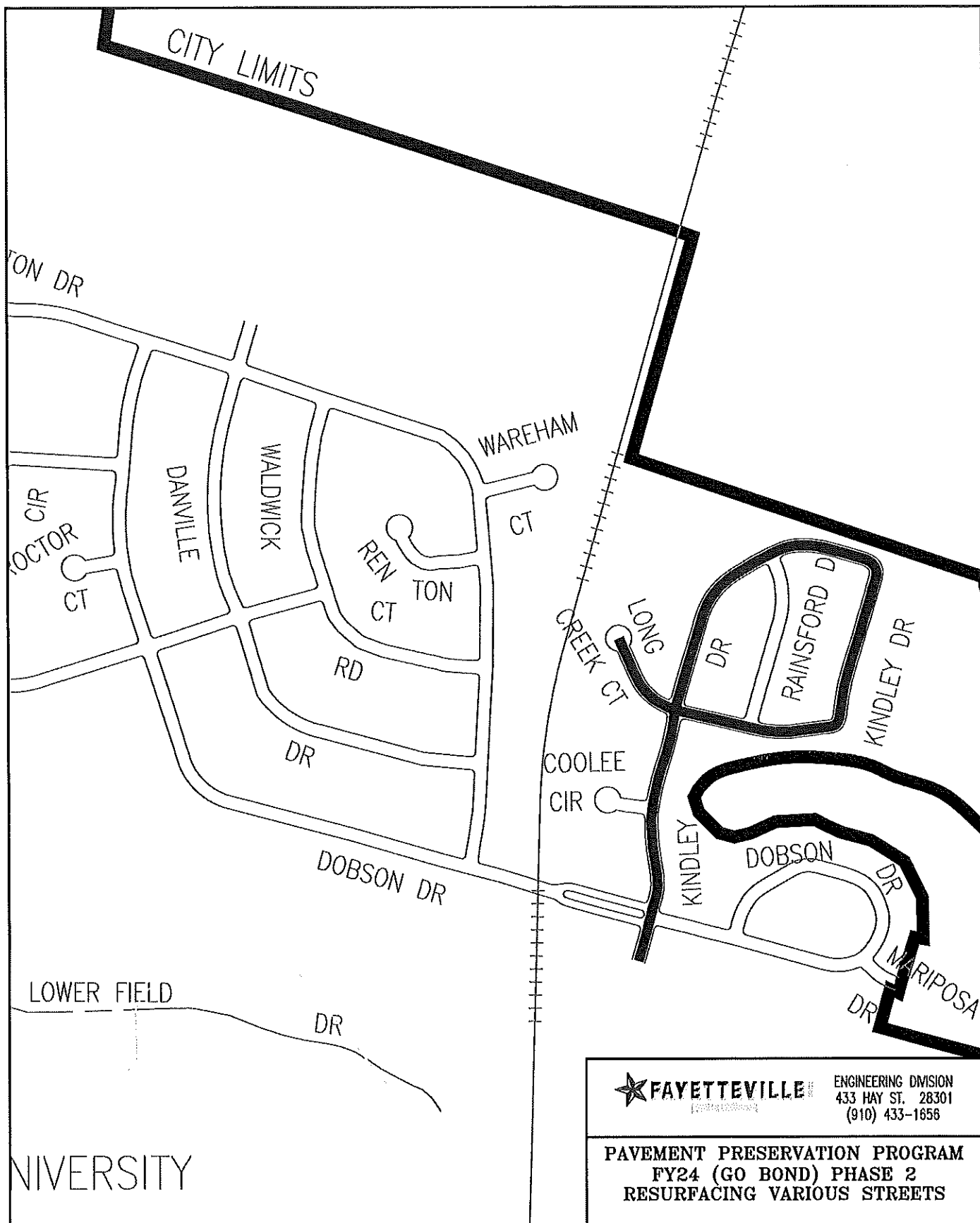

UNIVERSITY



ENGINEERING DIVISION  
433 HAY ST. 28301  
(910) 433-1656

**PAVEMENT PRESERVATION PROGRAM  
FY24 (GO BOND) PHASE 2  
RESURFACING VARIOUS STREETS**

THIS MAP IS NOT A CERTIFIED SURVEY AND  
HAS NOT BEEN REVIEWED BY A LOCAL  
GOVERNMENT AGENCY FOR COMPLIANCE  
WITH ANY APPLICABLE LAND DEVELOPMENT  
REGULATIONS.

LONG CREEK COURT  
KINDLEY DRIVE

DATE 10/12/2023

DRAWN BY RSH

SCALE 1"=500'

CK'D BY RSH

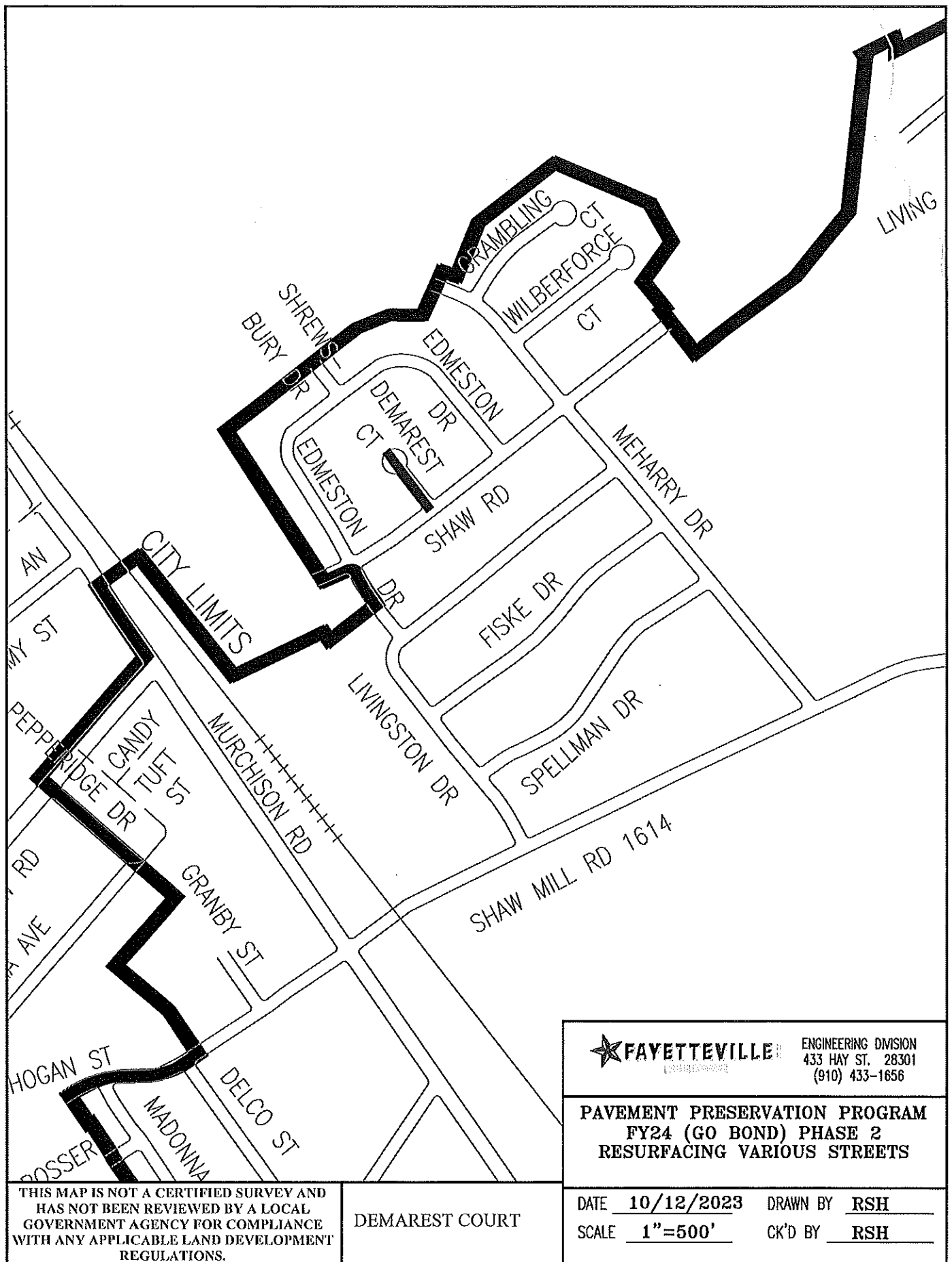

THIS MAP IS NOT A CERTIFIED SURVEY AND  
HAS NOT BEEN REVIEWED BY A LOCAL  
GOVERNMENT AGENCY FOR COMPLIANCE  
WITH ANY APPLICABLE LAND DEVELOPMENT  
REGULATIONS.

DEMAREST COURT



ENGINEERING DIVISION  
433 HAY ST. 28301  
(910) 433-1656

PAVEMENT PRESERVATION PROGRAM  
FY24 (GO BOND) PHASE 2  
RESURFACING VARIOUS STREETS

DATE 10/12/2023 DRAWN BY RSB  
SCALE 1"=500' CK'D BY RSB

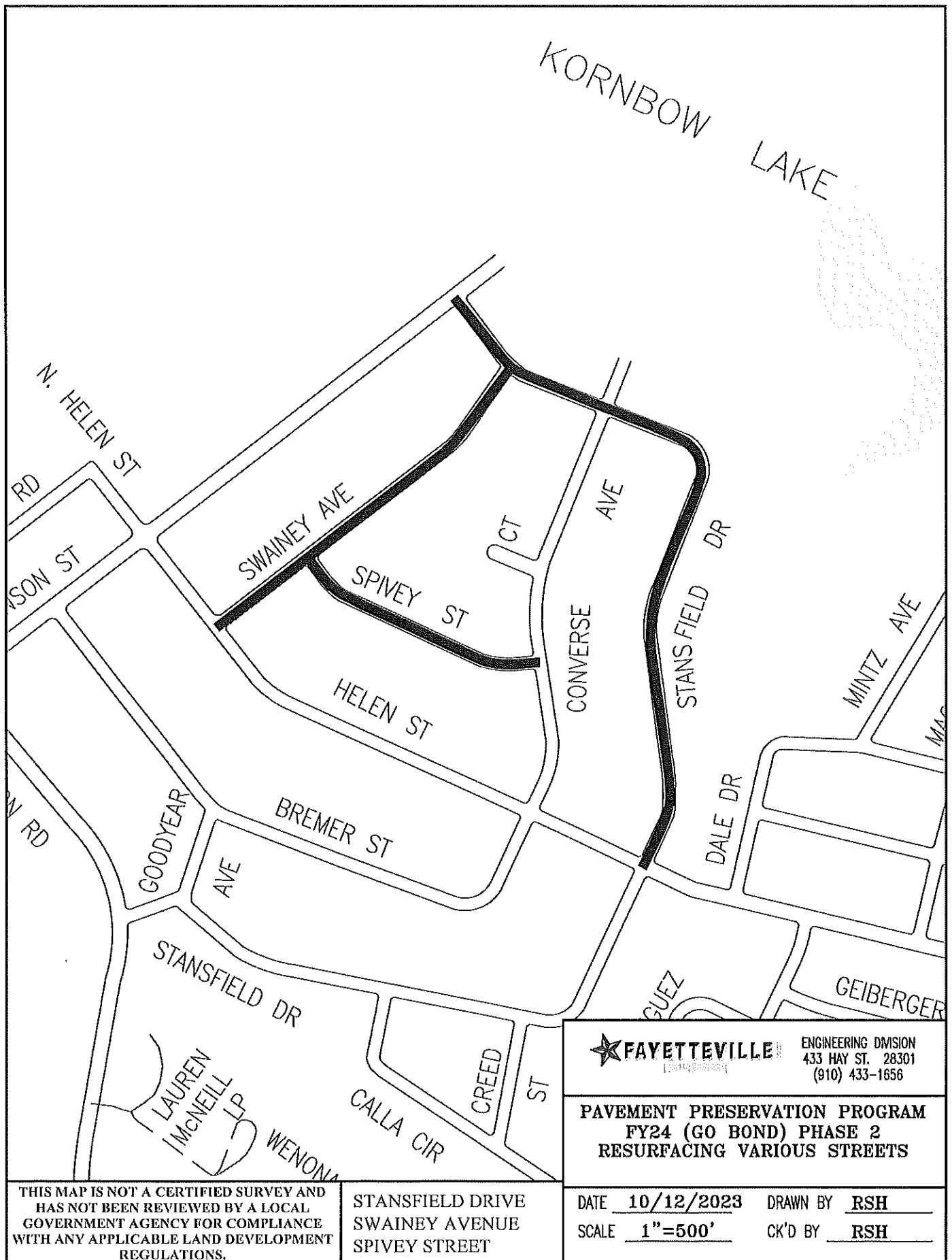

| Proposed Resurface Various Streets, 2024 GO Bond - Phase 2 |                |               |        |       |     |
|------------------------------------------------------------|----------------|---------------|--------|-------|-----|
| Proposed Milling & Resurfacing Streets                     |                |               |        |       |     |
| Profile Mill Streets                                       |                |               |        |       |     |
| STREET                                                     | FROM           | TO            | LENGTH | WIDTH | PCI |
| MCGILVARY ST                                               | ROBESON ST     | BRIDGE        | 2010   | 43    | 68  |
| ARBUTUS TRAIL                                              | LOFTON DR      | KINLAW RD     | 1600   | 27    | 63  |
| LAKEVIEW DR                                                | FOREST LAKE RD | VISTA DR      | 905    | 32    | 69  |
| FOREST LAKE RD                                             | VALLEY RD      | VISTA DR      | 1100   | 33    | 57  |
| Edge Mill Streets                                          |                |               |        |       |     |
| SANDHILL DR                                                | BOONE TRAIL    | FARGO DR      | 2183   | 34    | 60  |
| NORTH ST                                                   | LAMON ST       | MILAN RD      | 2811   | 32    | 40  |
| DOBSON DR                                                  | KINLAW RD      | DOBSON DR     | 4748   | 45    | 65  |
| Length                                                     |                |               | 15357  |       |     |
| Mileage                                                    |                |               | 2.91   |       |     |
| Proposed Resurfacing Streets                               |                |               |        |       |     |
| STREET                                                     | FROM           | TO            | LENGTH | WIDTH | PCI |
| GOINS DR                                                   | TINA DR        | OWEN DR       | 1140   | 27    | 56  |
| GRAY ST                                                    | ANN ST         | NORTH ST      | 1158   | 32    | 42  |
| TILLINGHAST ST                                             | NORTH ST       | MARSH ST      | 889    | 32    | 49  |
| MARSH ST                                                   | IRENE AVE      | GRAY ST       | 1089   | 32    | 52  |
| GLENWICK DR                                                | COVENTRY RD    | MARTINDALE DR | 2667   | 33    | 65  |
| MARTINDALE DR                                              | IRELAND DR     | GLENWICK DR   | 3307   | 33    | 66  |
| DURANT DR                                                  | SPEARS DR      | JEFFERSON DR  | 2400   | 20    | 68  |
| LONG CREEK CT                                              | KINDLEY DR     | CUL-DE-SAC    | 300    | 21    | 58  |
| KINDLEY DR                                                 | DEAD END       | KINDLEY DR    | 3310   | 26    | 56  |
| DEMAREST CT                                                | SHAW RD        | CUL-DE-SAC    | 210    | 21    | 58  |
| STANSFIELD DR                                              | JOHNSON ST     | HELEN ST      | 2900   | 20    | 56  |
| SWAINEY AVE                                                | STANSFIELD DR  | HELEN ST      | 1564   | 19    | 55  |
| SPIVEY ST                                                  | SWAINEY AVE    | CONVERSE AVE  | 1052   | 21    | 55  |
| Length                                                     |                |               | 21986  |       |     |
| Mileage                                                    |                |               | 4.16   |       |     |
| Total Length                                               |                |               | 37343  |       |     |
| Total Mileage                                              |                |               | 7.07   |       |     |

\*\*\* A street on the list may change to another year due to Funding, Construction and/or