

**SITE PLAN**

SCALE: 1/32"=1'-0"

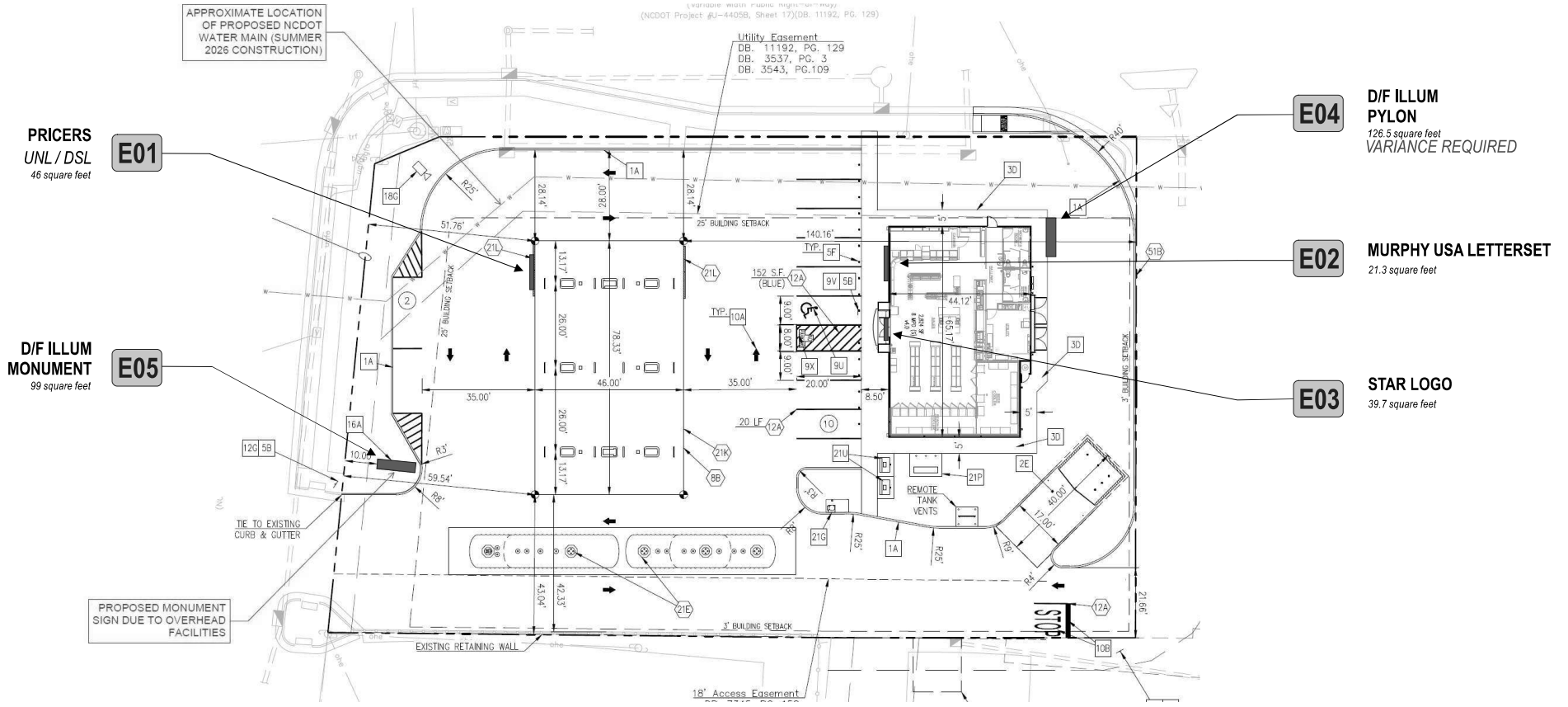

- E04** D/F ILLUM PYLON  
126.5 square feet  
VARIANCE REQUIRED
- E02** MURPHY USA LETTERSET  
21.3 square feet
- E03** STAR LOGO  
39.7 square feet

- E01** PRICERS UNL / DSL  
46 square feet
- E05** D/F ILLUM MONUMENT  
99 square feet

**Stratus**  
onestratus.com  
8959 Tyler Boulevard  
Mentor, Ohio 44060  
888.503.1569

CLIENT:  
**MURPHY USA**  
ADDRESS:  
105 Hope Mills Rd  
Fayetteville, NC 28304

ORDER NUMBER:  
1243046  
SITE NUMBER:  
25122  
ELECTRONIC FILE NAME:  
G:\ACCOUNTS\MURPHY'S USA\LOCATIONS\2025\NC\25122\_Fayetteville\25122\_Fayetteville Visibility R4.cdr

PROJECT NUMBER:  
82972  
PROJECT MANAGER:  
WAYNE MCGAHEE

Rev #	Req #	Date/Artist	Description	Rev #	Req #	Date/Artist	Description
Original	552005	09/12/25 KW					
Rev 1	569878	12/23/25 KW	Revised site plan				
Rev 2	572015	01/08/26 KW	Revised monument				
Rev 3	572739	01/14/26 KW	Updated sf				
Rev 4	593990	04/24/26 KW	Updated address				

PRINTS ARE THE EXCLUSIVE PROPERTY OF STRATUS. THIS MATERIAL SHALL NOT BE USED, DUPLICATED, OR OTHERWISE REPRODUCED WITHOUT THE PRIOR WRITTEN CONSENT OF STRATUS.

E04

D/F ILLUM. PYLON

Scale: 3/16"=1'-0"

PY126.i

126.5 square feet

VARIANCE REQUIRED

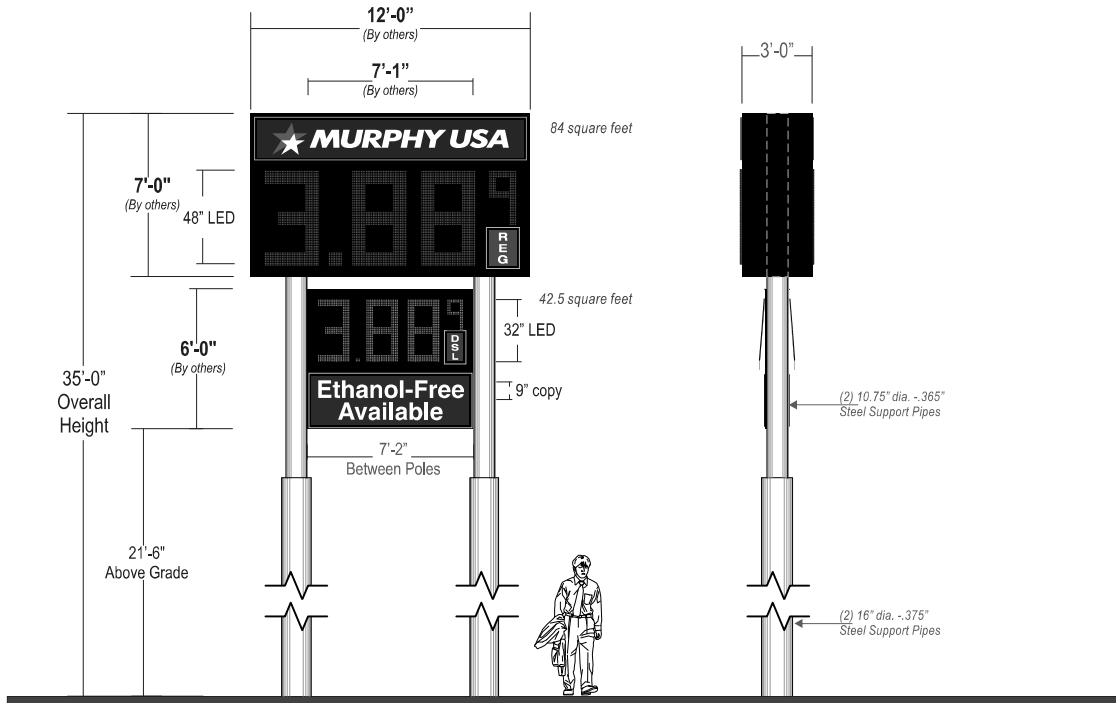

**MAIN CABINET:** 36" deep D/F Illum. cabinet provided BY OTHERS

**SECONDARY CABINET:** 12" deep D/F Illum. cabinets provided BY OTHERS  
(1) one of each cabinet shown required

**SUPPORT POLE:** (2) Two telescoping support poles required, painted to match Murphys specs;

**INSTALL:** Direct burial installation as required by city code and engineering requirements;  
*ADDITIONAL INSTALL AND FOUNDATION DETAILS TO FOLLOW*

**QUANTITY:** (1) One Required

**JOB NOTES:** Sign cabinet to be provided by others; STRATUS to install STRATUS responsible for footer/ foundation/ support poles

ALL SIGNS TO COMPLY WITH UL 48 AND WILL BE MARKED AS SUCH WITH APPROPRIATE LABORATORY LABELS.

THIS SIGN IS INTENDED TO BE INSTALLED IN ACCORDANCE WITH THE REQUIREMENTS OF ARTICLE 600 OF THE NATIONAL ELECTRICAL CODE AND/OR OTHER APPLICABLE LOCAL CODES. THIS INCLUDES PROPER GROUNDING AND BONDING OF THE SIGN.

THE LOCATION OF THE DISCONNECT SWITCH AFTER INSTALLATION SHALL COMPLY WITH ARTICLE 600.6(A) (1) OF THE NATIONAL ELECTRIC CODE.

**SIGN TO BE U.L. LISTED AND SHALL MEET N.E.C. STANDARDS**

**Underwriters Laboratories Inc. ELECTRIC SIGN**

ALL ELECTRICAL COMPONENTS TO BE U.L. LISTED, APPROVED AND MARKED PER N.E.C. 600-4. ALL TO BE ELECTRICALLY GROUNDING PER N.E.C. 250. ALL POWER SUPPLIES TO BE LISTED PER U.L. 48, 250.1 GROUNDING AND BONDING PER N.E.C. 250-90, -92, -94, -96.

SIGN TO MEET N.E.C. AND U.L. 48 STANDARDS FOR ELECTRICAL SIGNS, GROUNDING & BONDING AS PER N.E.C. 250-90 & NEC 600-7

**Stratus**

onestratus.com  
8959 Tyler Boulevard  
Mentor, Ohio 44060  
888.503.1569

**CLIENT:**  
**MURPHY USA**

**ADDRESS:** 105 Hope Mills Rd  
Fayetteville, NC 28304

**PAGE NO.:** 8

**ORDER NUMBER:** 1243046

**PROJECT NUMBER:** 82972

**SITE NUMBER:** 25122

**PROJECT MANAGER:** WAYNE MCGAHEE

**ELECTRONIC FILE NAME:**  
G:\ACCOUNTS\MURPHY'S USA\LOCATIONS\2025\NC\25122\_Fayetteville\25122\_Fayetteville Visibility R4.cdr

Rev #	Req #	Date/Artist	Description	Rev #	Req #	Date/Artist	Description
Original	552005	09/12/25 KW					
Rev 1	569878	12/23/25 KW	Revised OAH				
Rev 2	572015	01/08/26 KW					
Rev 3	572739	01/14/26 KW	Updated logo				
Rev 4	593990	04/24/26 KW	Updated address				

PRINTS ARE THE EXCLUSIVE PROPERTY OF STRATUS. THIS MATERIAL SHALL NOT BE USED, DUPLICATED, OR OTHERWISE REPRODUCED WITHOUT THE PRIOR WRITTEN CONSENT OF STRATUS.