

2018 APPENDIX B
BUILDING CODE SUMMARY FOR ALL COMMERCIAL PROJECTS
(EXCEPT 1 AND 2-FAMILY DWELLINGS AND TOWNHOUSES)

Name of Project: 4D SIGNS
Address: 328 PERSON ST LLC
Owner/Authorized Agent: 328 PERSON ST LLC

CONTACT: ZYAD MUSMAR
Architectural: ZYAD MUSMAR ARCHITECT
Civil: ZYAD MUSMAR ARCHITECT
Electrical: ZYAD MUSMAR ARCHITECT

2018 NC BUILDING CODE:
2018 NC EXISTING BUILDING CODE:
CONSTRUCTED: (date) 1971
RENOVATED: (date) 2023

BASIC BUILDING DATA
Construction Type:
Sprinklers:
Standpipes:
Primary Fire District:
Special Inspections Required:

GROSS BUILDING AREA TABLE
FLOOR: 3rd Floor, 2nd Floor, Mezzanine, 1st Floor, Basement
EXISTING (SQ FT), NEW (SQ FT), SUB-TOTAL

ALLOWABLE AREA
Primary Occupancy Classification(s):
Assembly, Business, Educational, Factory, Hazardous, Institutional

Accessory Occupancy Classification(s):
Incidental Uses (Table 509):
Special Uses (Chapter 4 - List Code Sections):
Special Provisions (Chapter 5 - List Code Sections):

STORY NO. DESCRIPTION AND USE
EXISTING BUILDING, 26,388 SQ FT
F-2 IB CONSTRUCTION TYPE AREA = 23,000
INCREASE FOR FRONTAGE = 0.16, TOTAL ALLOWABLE AREA WITH FRONTAGE = 26,680

ALLOWABLE HEIGHT
Building Height in Feet (Table 504.3)
Building Height in Stories (Table 504.4)

FIRE PROTECTION REQUIREMENTS
BUILDING ELEMENT: Structural Frame, Exterior Walls, Interior Walls, etc.

FIRE PROTECTION REQUIREMENTS (continued)
BUILDING ELEMENT: Floor Construction, Column Supporting Floors, etc.

PERCENTAGE OF WALL OPENING CALCULATIONS
EXISTING BUILDING

Table with 4 columns: FIRE SEPARATION DISTANCE, DOUBLE OF OPENING PROTECTION, ALLOWABLE AREA (%), ACTUAL BROWS OR PLANS (%)

LIFE SAFETY SYSTEM REQUIREMENTS
Emergency Lighting:
Exit Signs:
Fire Alarm:
Smoke Detection Systems:
Carbon Monoxide Detection:

LIFE SAFETY PLAN REQUIREMENTS
Life Safety Plan Sheet #: G0001
Fire and/or smoke rated wall locations (Chapter 7):
Assumed and real property line locations (if not on the site plan):

ACCESSIBLE DWELLING UNITS (SECTION 1107)
ACCESSIBLE PARKING (SECTION 1106)
PLUMBING FIXTURE REQUIREMENTS (TABLE 2902.1)

ACCESSIBLE DWELLING UNITS (SECTION 1107)
TOTAL UNITS, ACCESSIBLE UNITS, TYPE A UNITS, TYPE B UNITS

ACCESSIBLE PARKING (SECTION 1106)
TOTAL # OF PARKING SPACES PROVIDED, TOTAL # ACCESSIBLE UNITS

PLUMBING FIXTURE REQUIREMENTS (TABLE 2902.1)
USE: WATER CLOSETS, SINKS, LAVATORIES, SHOWERS, DRINKING FOUNTAINS

SPECIAL APPROVALS
Special approval: (Local Jurisdiction, Department, etc., describe below)
N/A

ENERGY REQUIREMENTS
The following data shall be considered minimum and any special attribute required to meet the energy code shall also be provided.

Existing building envelope complies with code:
Exempt Building:
Climate Zone:
Method of Compliance:

THERMAL ENVELOPE (Prescriptive method only)
Roof/ceiling Assembly (each assembly):
Description of assembly:
U-Value of total assembly:
R-Value of insulation:
Skylights in each assembly:
U-Value of skylight:
total square footage of skylights in each assembly:

Roof/ceiling Assembly (each assembly):
Description of assembly:
U-Value of total assembly:
R-Value of insulation:
Skylights in each assembly:
U-Value of skylight:
total square footage of skylights in each assembly:

Exterior Walls (each assembly):
Description of assembly:
U-Value of total assembly:
R-Value of insulation:
Openings (windows or doors with glazing):
U-Value of assembly:
Solar heat gain coefficient:
projection factor:
Door R-Values:

Exterior Walls (each assembly):
Description of assembly:
U-Value of total assembly:
R-Value of insulation:
Openings (windows or doors with glazing):
U-Value of assembly:
Solar heat gain coefficient:
projection factor:
Door R-Values:

Exterior Walls (each assembly):
Description of assembly:
U-Value of total assembly:
R-Value of insulation:
Openings (windows or doors with glazing):
U-Value of assembly:
Solar heat gain coefficient:
projection factor:
Door R-Values:

Exterior Walls (each assembly):
Description of assembly:
U-Value of total assembly:
R-Value of insulation:
Openings (windows or doors with glazing):
U-Value of assembly:
Solar heat gain coefficient:
projection factor:
Door R-Values:

Walls below grade (each assembly):
Floors over unconditioned space (each assembly):
Floors slab on grade:

STRUCTURAL DESIGN
DESIGN LOADS:
Importance Factors:
Live Loads:
Ground Snow Load:
Wind Load:

SEISMIC DESIGN CATEGORY:
Provide the following Seismic Design Parameters:
Occupancy Category (Table 1604.5):
Spectral Response Acceleration Sa:
Site Classification (ASCE 7):
Basic structural system (check one):
Analysis Procedure:
Architectural, Mechanical, Components anchored?

LATERAL DESIGN CONTROL:
SOIL BEARING CAPACITIES:
Field Test (provide copy of test report):
Presumptive Bearing capacity:
Pile size, type, and capacity:

MECHANICAL DESIGN
MECHANICAL SUMMARY
MECHANICAL SYSTEMS, SERVICE SYSTEMS AND EQUIPMENT

Thermal Zone:
Interior design conditions:
Building heating load:
Building cooling load:
Mechanical Spacing Conditioning System:
description of unit:
heating efficiency:
cooling efficiency:
size category of unit:
Boiler:
Chiller:
List equipment efficiencies:

ELECTRICAL DESIGN
ELECTRICAL SUMMARY
ELECTRICAL SYSTEM AND EQUIPMENT
Method of Compliance:
Lighting schedule (each fixture type):
lamp type required in fixture
number of lamps in fixture
ballast type used in the fixture
number of ballasts in fixture
total wattage per fixture
total interior wattage specified vs. allowed (whole building or space by space)
total exterior wattage specified vs. allowed

Additional Prescriptive Compliance:
306.2.1 More Efficient Mechanical Equipment
306.2.2 Reduced Lighting Power Density
306.2.3 Energy Recovery Ventilation Systems
306.2.4 Higher Efficiency Service Water Heating
306.2.5 On-Site Supply of Renewable Energy
306.2.6 Automatic Daylighting Control Systems

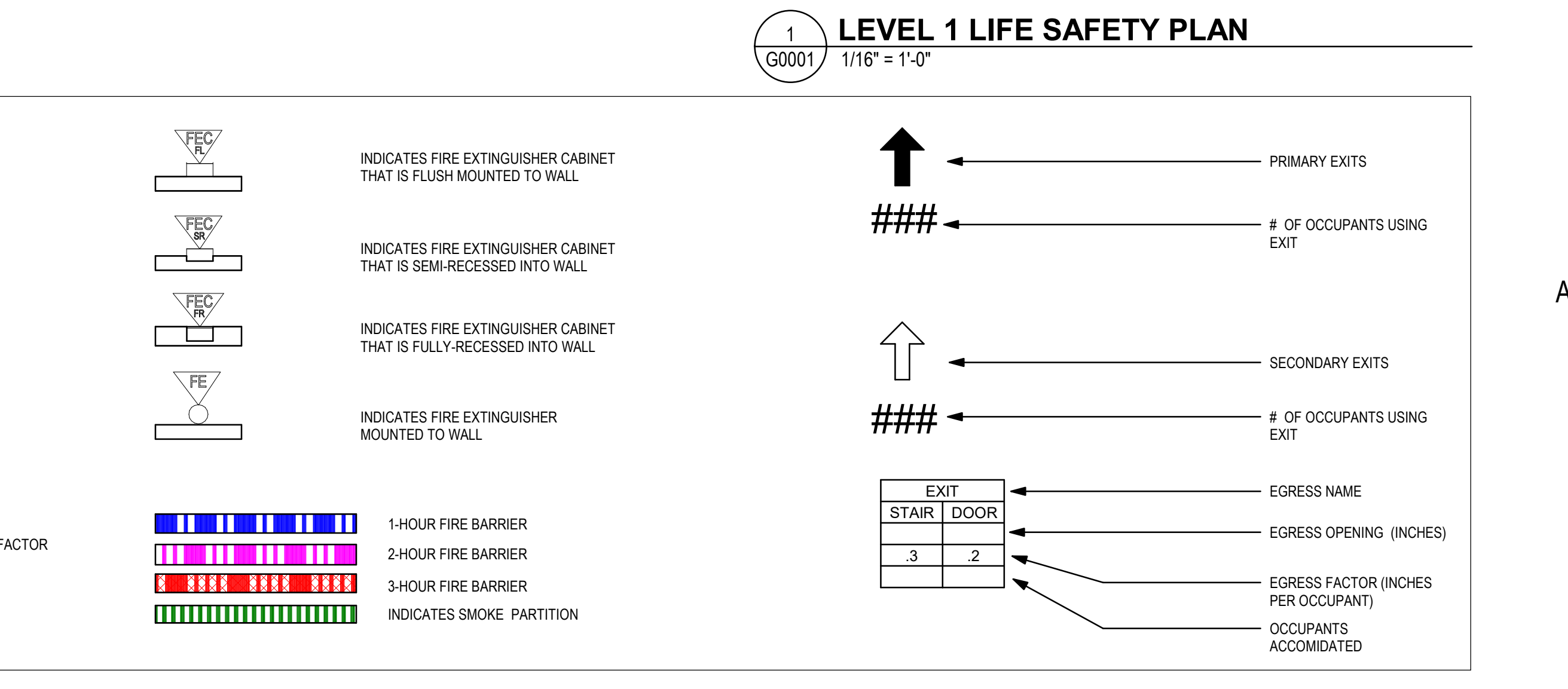
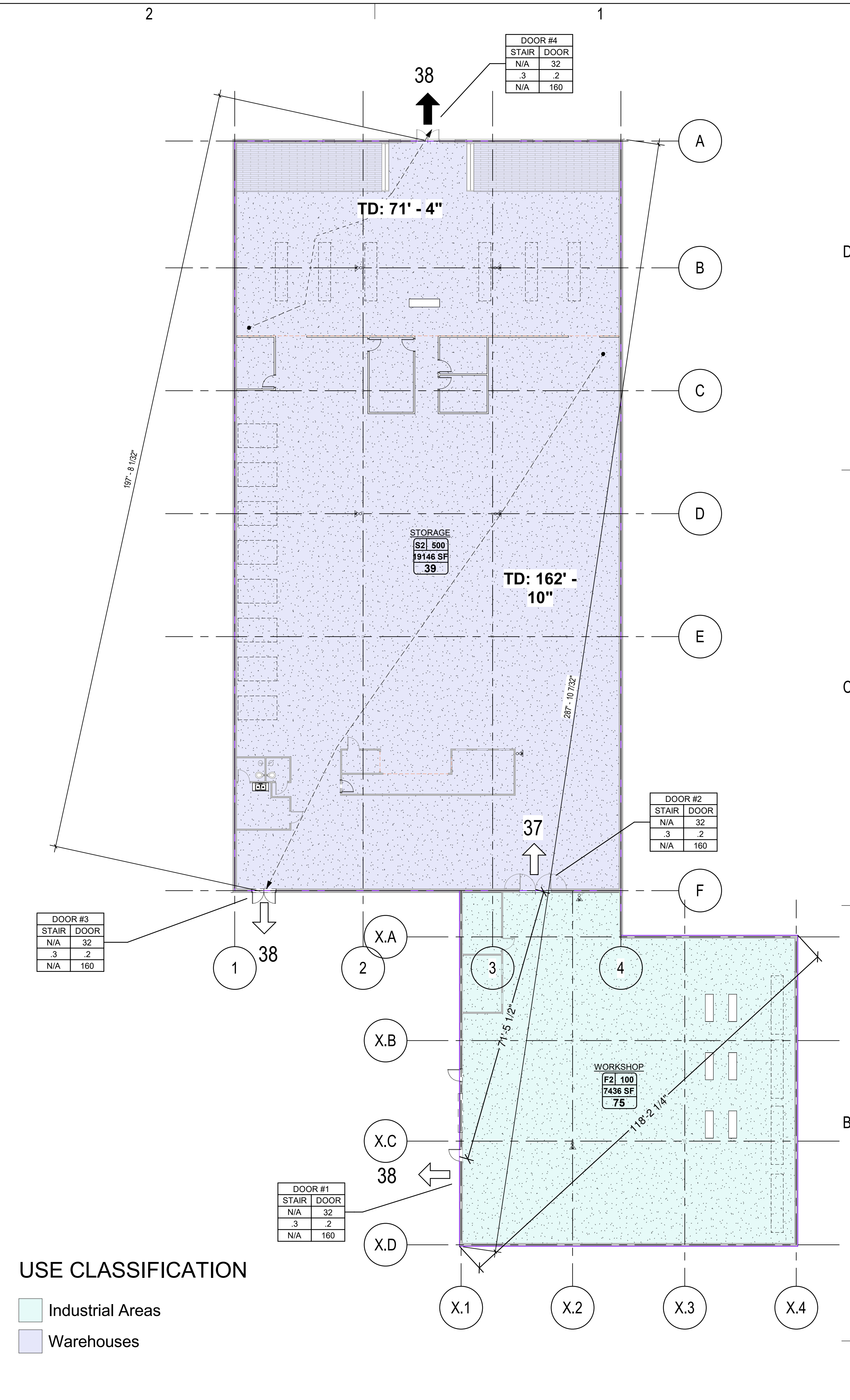

Professional seal for Zeyad Musmar Architect, Durham, NC. Includes project details: 4D SIGNS, 328 PERSON STREET, FAYETTEVILLE, NC 28001. ISSUED SETS: FC 06.22.23. Drawn By: ZMM, Project No: 23011. CODE SUMMARY & LIFE SAFETY SHEET.

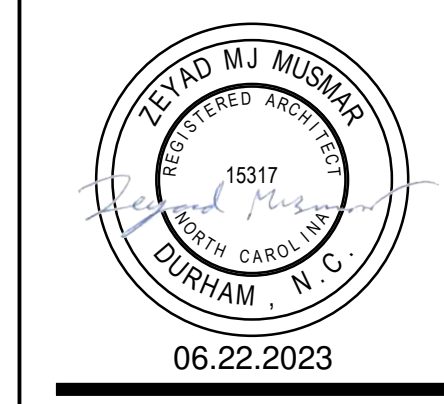

06.22.2023

REV #	DESCRIPTION	DATE

4D SIGNS
 338 PERSON STREET
 FAYETTEVILLE, NC 28011

IFC	ISSUED SETS

Drawn By: ZMM
 Project No.: 23011

A1101
 FIRST FLOOR PLAN

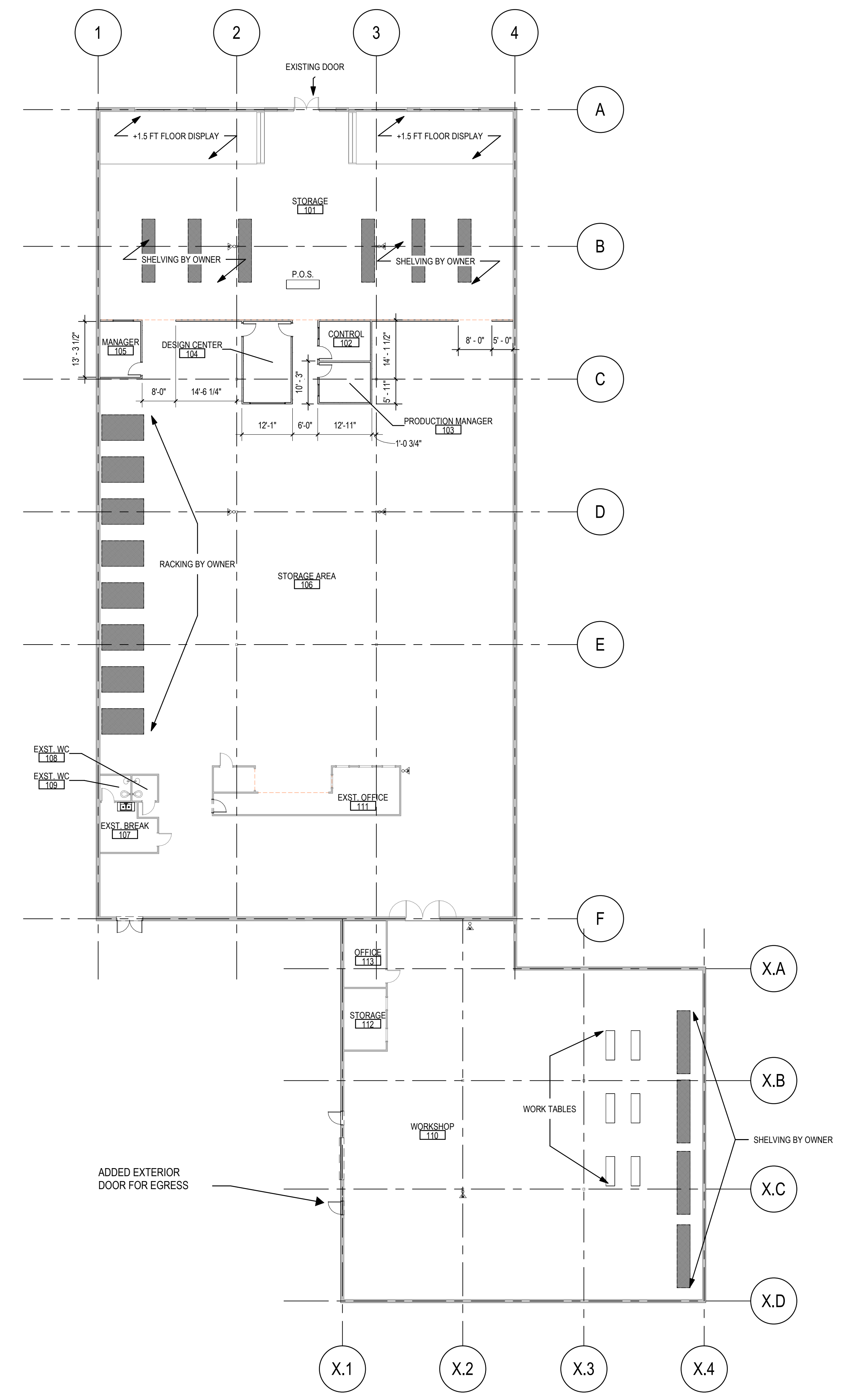

A2 FIRST FLOOR PLAN
 A1101 1/16" = 1'-0"

GENERAL NOTES

- INTERIOR DIMENSIONS ARE TO THE FACE OF PARTITION AS INDICATED, UNLESS OTHERWISE NOTED.
- SEE ENLARGED PLANS (TOILET, STAIRS, ELEVATORS, ETC) FOR DIMENSIONS IN THOSE AREA.
- PROVIDE FIRE SEALANT / SAFING AT JOINTS BETWEEN RATED WALLS AND STRUCTURE AND AT PENETRATIONS OF RATED WALL, FLOORS, AND ROOF ASSEMBLIES. PROVIDE SMOKE & ACOUSTIC BARRIER AT TOP OF ALL NON-RATED CMU WALLS THAT EXTEND TO STRUCTURE.
- SEE PLUMBING DRAWINGS FOR FLOOR DRAIN LOCATIONS. SLOPE CERAMIC AND ALL MUD SET TILE FLOORS TO DRAINS.
- "FEC" DENOTES FIRE EXTINGUISHER CABINET AND EXTINGUISHER
 "FE" DENOTES FIRE EXTINGUISHER AND BRACKET.
- M.O. INDICATES MASONRY OPENINGS AS NOMINAL DIMENSIONS
- PROVIDE THE FOLLOWING STENCILED WORDING ABOVE CEILING "FIRE AND SMOKE BARRIER, PROTECT ALL OPENINGS AT SMOKE STOP PARTITION AND FIRE RATED WALLS." ALSO STENCIL EXACTLY WHAT TYPE OF RATING EACH WALL IS. FOR EXAMPLE: "1-HOUR FIRE BARRIER, 2-HOUR FIRE BARRIER, SMOKE PARTITION, ETC."
- "OF" DENOTES OWNER FURNISHED, CONTRACTOR INSTALLED.
 "OF" DENOTES OWNER FURNISHED, OWNER INSTALLED.
 "CF" DENOTES CONTRACTOR FURNISHED, CONTRACTOR INSTALLED.

FLOOR PLAN LEGEND

	1-HOUR FIRE BARRIER
	2-HOUR FIRE BARRIER
	3-HOUR FIRE BARRIER
	INDICATES SMOKE PARTITION
	INDICATES CAST CONCRETE
	INDICATES CONCRETE MASONRY UNITS
	INDICATES BRICK MASONRY
	INDICATES STEEL STUD FRAMED PARTITIONS
	INDICATES FIRE EXTINGUISHER CABINET THAT IS FLUSH MOUNTED TO WALL
	INDICATES FIRE EXTINGUISHER CABINET THAT IS SEMI-RECESSED INTO WALL
	INDICATES FIRE EXTINGUISHER CABINET THAT IS FULLY-RECESSED INTO WALL
	INDICATES FIRE EXTINGUISHER MOUNTED TO WALL